

FIRST Robotics

Specification Sheet for MRS-.087-BL

Description:

3 Wire Band Mount Reed Switch

LED indicator

This is a 3 wire device with wires internally connected to a reed switch element and an LED. Specifications are valid for resistive loads only. Choosing a switch is governed by our published load current derating curves. These are derived from the switch contact rating, expressed in wattage. The LED indicator assists for easy set-up.

How it Works:

Reed switches contain hermetically-sealed reeds, or contacts. When the magnet on the piston moves close to the switch, the reeds become magnetized and the normally open contacts will close or pull in. The resulting signal can be used to signal or control other operations in the system. When the magnet moves away from the piston, the contacts will open or drop out.

Specifications:

Model Number	MRS-087-BL
Contacts	SPST Form A (Normally Open)
Contact Rating	9 Watts Max.
Switch Voltage	6-24 Volts DC
Maximum Current	500mA resistive
Initial Contact Resistance	0.10 Ohms Max
Actuating Time Average	1.0 millisecond

Electrical Circuit Diagram

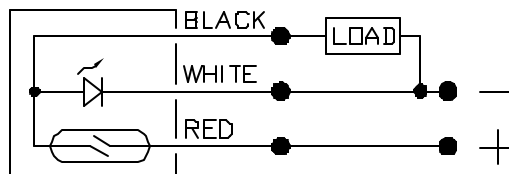

Mounting

The switch can be mounted anywhere along the length and circumference of the actuator body. Mounting hardware includes the switch, a band, a U-shaped

bracket and a screw (included). 2-3 in-lbs of torque are recommended for mounting.

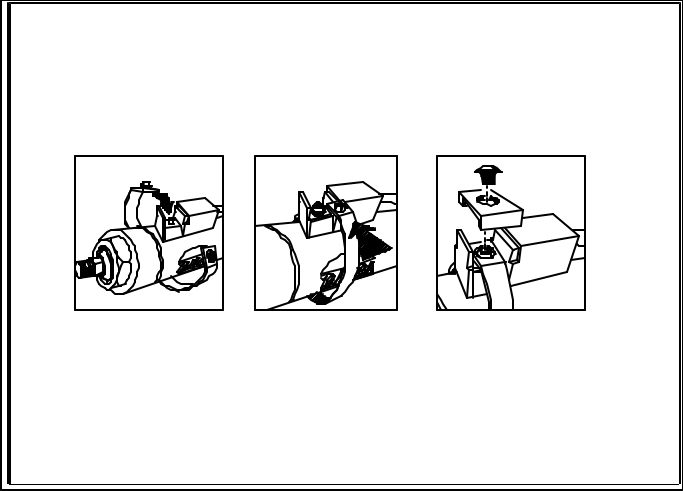

Dimensions